



## JUDD HALL

Opened in 1929, Judd Hall is an all-female residence hall in the center of campus. It has double rooms, where two students share a bedroom, and each hall shares a bathroom. Each bedroom includes two beds, two closets/dressers, a sink, and two desks/chairs. The building lobby offers a television, games, couches and chairs. The first floor features laundry machines, and The Cellar coffeeshop is in the basement of the building.



### Judd Hall Features:

- 2 stories, 59 beds
- Double rooms with Hall Bath
- The Cellar Coffeeshop in basement
- Laundry Facilities
- Keycard access for security
- Quiet study room



[\\_communitylife@smcsc.edu](mailto:_communitylife@smcsc.edu)

## JUDD HALL | Double Room

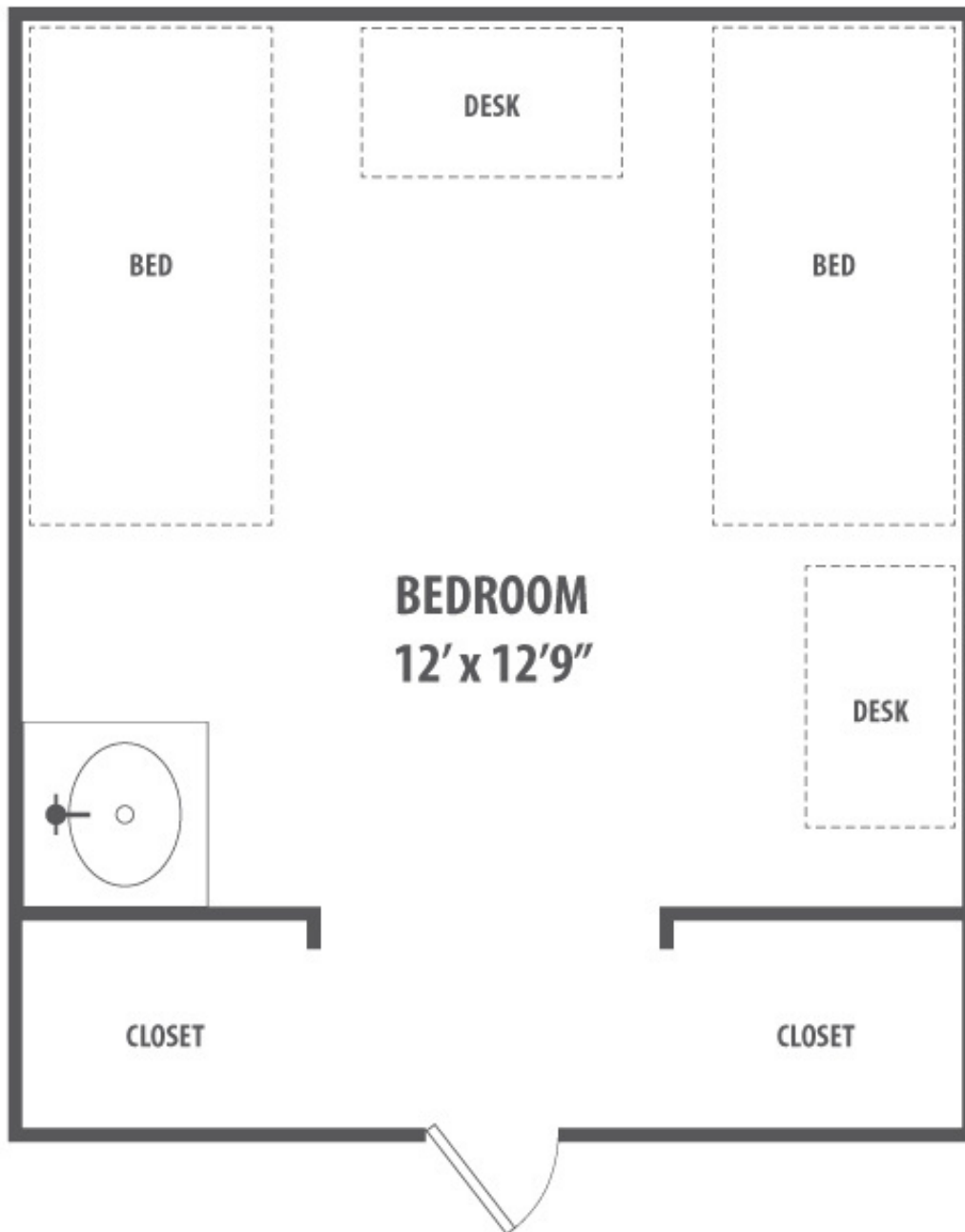

### Measurements

- Desk: 42"W x 30"H x 24"D
- Mattress Size: Extra Long Twin 80" x 39"
- Storage Under Bed: 80"W x 33"H x 38"D (when bed is at highest setting)
- Dresser: 30"W x 30"H x 20"D
- Closet: Two at 36"W x 42"D each

### Furnishings

- Bedroom
  - Bed
  - Desk & Chair
  - Dresser
- Hall Bathroom
- Carpet in Bedroom
- In-room sink