



PARSONS HALL

Vera Davis Parsons Hall is a coed residence hall. It has double suites, where two students share a room and two rooms share a bathroom. Each bedroom includes two beds, two closets/dressers, and two desks/chairs. The building lobby offers a television, games, couches and chairs. The first floor features a vending machine area, and laundry machines, while the second floor has a study room with quiet seating,



Parsons Hall Features:

- 2 stories, 44 beds
- Double suites
- Elevator
- Vending Machines
- Laundry Facilities
- Keycard access for security
- Quiet study room

X *experience*
COMMUNITY

_communitylife@smcsc.edu

PARSONS HALL | Double Suite

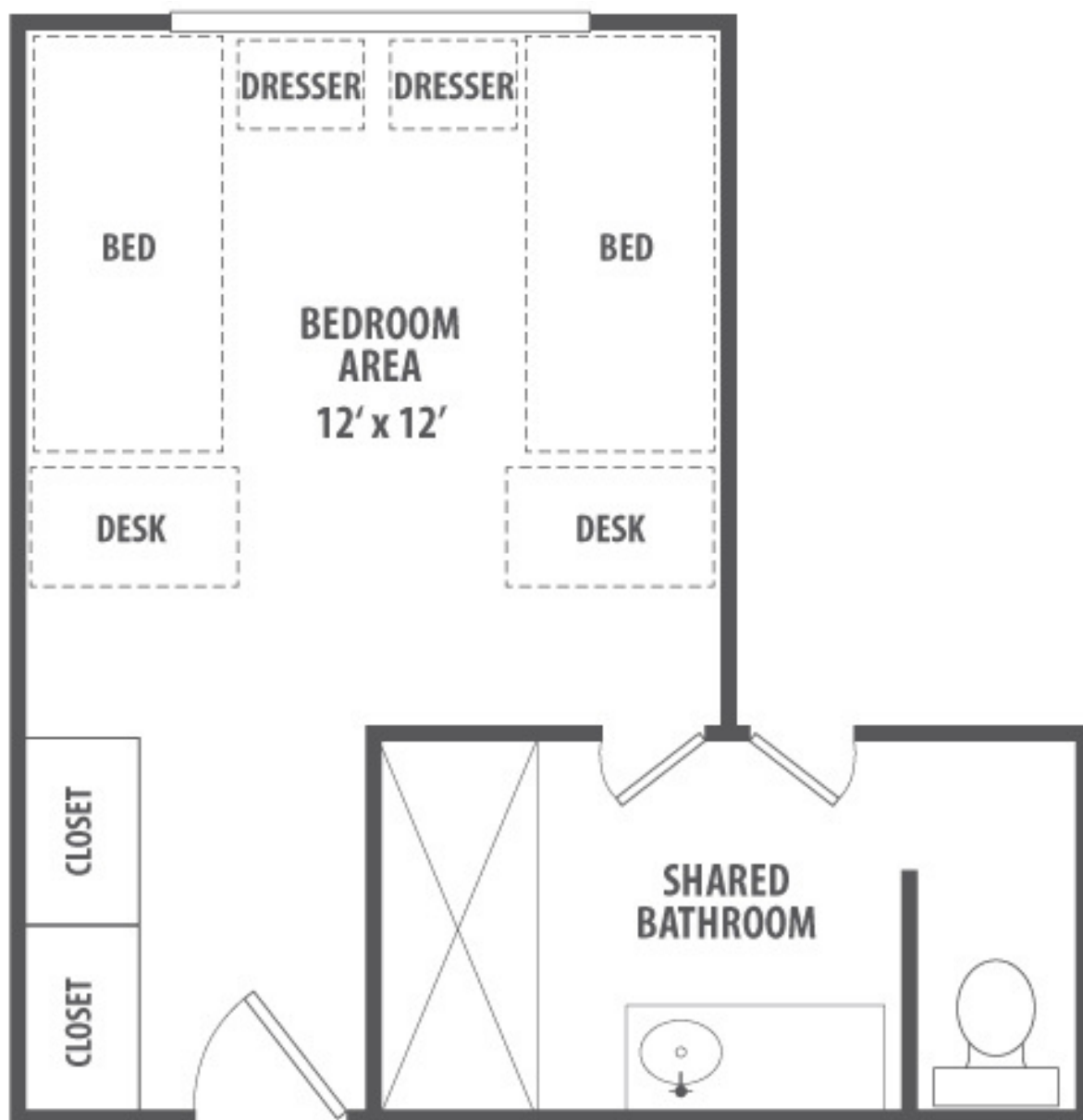

Measurements

- Desk: 42"W x 30"H x 24"D
- Mattress Size: Extra Long Twin 80" x 39"
- Storage Under Bed: 80"W x 33"H x 38"D (when bed is at highest setting)
- Dresser: 23"W x 45"H x 18"D
- Closet: Two at 36"W x 24"D each
- Shower Stall: 32"D x 60"W

Furnishings

- Bedroom
 - Bed
 - Desk & Chair
 - Dresser
- Shared Bathroom
- Carpet in Bedroom
- Tile Floor in Bathroom